



23 Calton Road, Gloucester, GL1 5DZ

£1,250 Per Month

This very well presented two bedroom family home is located on Calton Road, ready to move into From February 2025!

Comprising of: Entrance hall, lounge / dining room with period features, a modern fitted kitchen with snug area and double patio doors leading to the private enclosed garden. Upstairs there are two double bedrooms, office room and modern family bathroom with shower over bath.

- Three Bedrooms
- Immaculate Throughout
  - Lounge / Diner
  - Modern Kitchen
- Private Enclosed Garden
- Available February!

Full virtual tour available, call to book your viewing!

Approx Gross Internal Area  
76 sq m / 820 sq ft

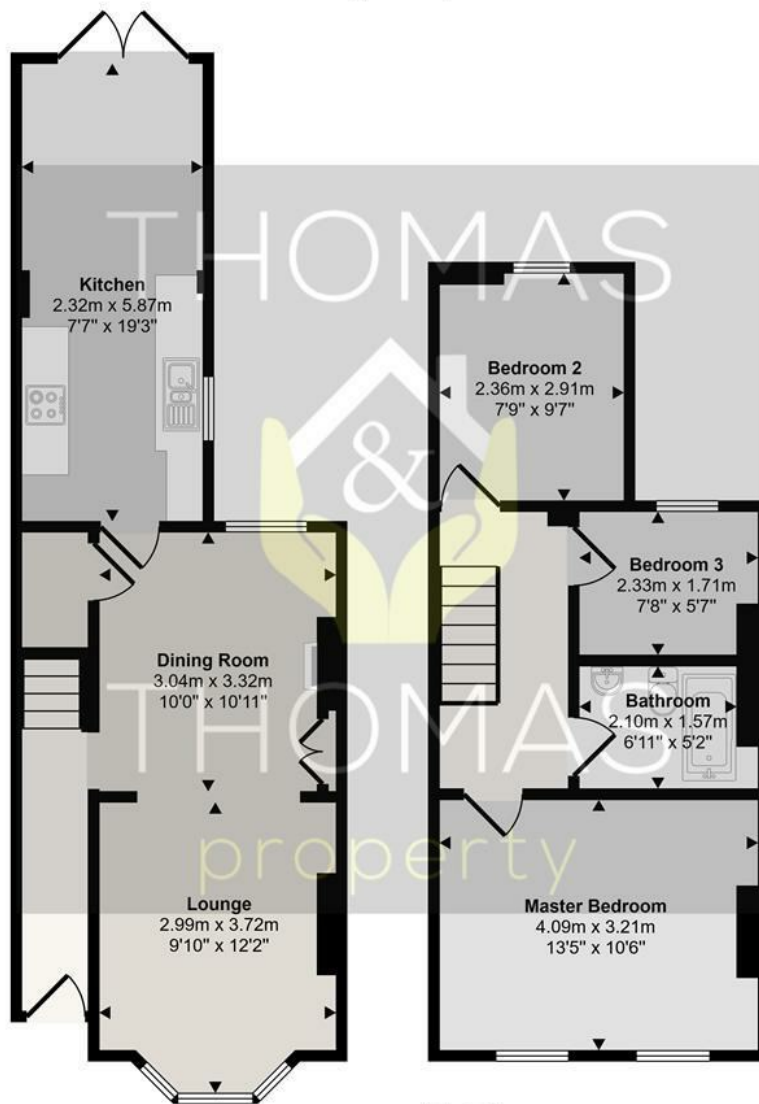

**Ground Floor**  
Approx 41 sq m / 440 sq ft

**First Floor**  
Approx 35 sq m / 380 sq ft

This floorplan is only for illustrative purposes and is not to scale. Measurements of rooms, doors, windows, and any items are approximate and no responsibility is taken for any error, omission or mis-statement. Icons of items such as bathroom suites are representations only and may not look like the real items. Made with Made Snappy 360.

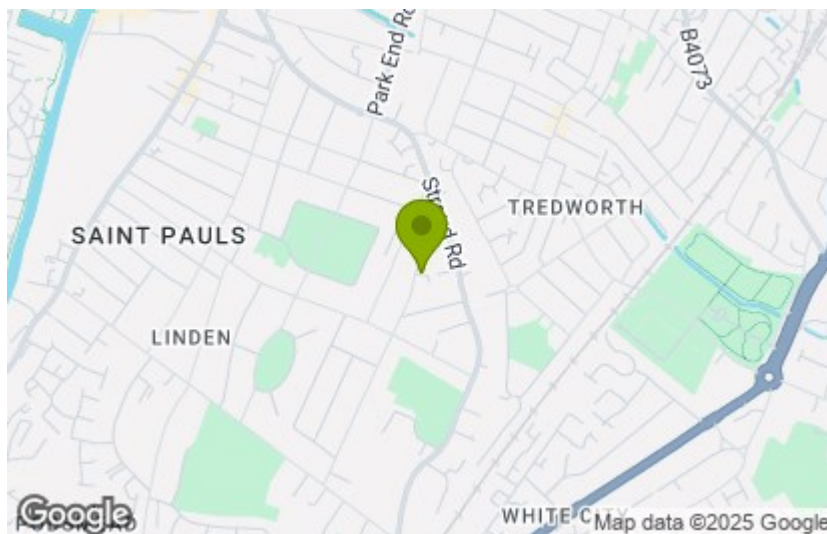

Energy Efficiency Rating		Current	Potential
Very energy efficient - lower running costs			
(92 plus) <b>A</b>			
(81-91) <b>B</b>			
(69-80) <b>C</b>			
(55-68) <b>D</b>			
(39-54) <b>E</b>			
(21-38) <b>F</b>			
(1-20) <b>G</b>			
Not energy efficient - higher running costs			
<b>England &amp; Wales</b>	EU Directive 2002/91/EC		

Environmental Impact (CO <sub>2</sub> ) Rating		Current	Potential
Very environmentally friendly - lower CO <sub>2</sub> emissions			
(92 plus) <b>A</b>			
(81-91) <b>B</b>			
(69-80) <b>C</b>			
(55-68) <b>D</b>			
(39-54) <b>E</b>			
(21-38) <b>F</b>			
(1-20) <b>G</b>			
Not environmentally friendly - higher CO <sub>2</sub> emissions			
<b>England &amp; Wales</b>	EU Directive 2002/91/EC		

These particulars, whilst believed to be accurate are set out as a general outline only for guidance and do not constitute any part of an offer or contract. Intending purchasers should not rely on them as statements of representation of fact, but must satisfy themselves by inspection or otherwise as to their accuracy. No person in this firm's employment has the authority to make or give any representation or warranty in respect of the property.