



125 Castlemeads Court Westgate Street, Gloucester, GL1 2BP Price £110,000

Thomas and Thomas are pleased to present this one double bedroom retirement property located in Castlemeads Court, centrally positioned and benefiting from impressive views of the Cathedral and across Gloucestershire.

Castlemeads Court was constructed by McCarthy & Stone (Developments) Ltd and benefits from having a development manager who can be contacted from various points within each property in the case of an emergency and communal areas.

Briefly comprising of: Entrance hall with storage cupboard, one double bedroom with built in storage and bathroom with shower over bath. The open plan lounge, diner, kitchen offers comfortable living. The main feature of this property has to be the circular dining room with panoramic windows and impressive views.

- Over 55's Retirement Property
 - Top Floor
 - One Double Bedroom
- Open Plan Lounge / Diner
 - Impressive Views
 - Central Location

Approx Gross Internal Area
66 sq m / 709 sq ft

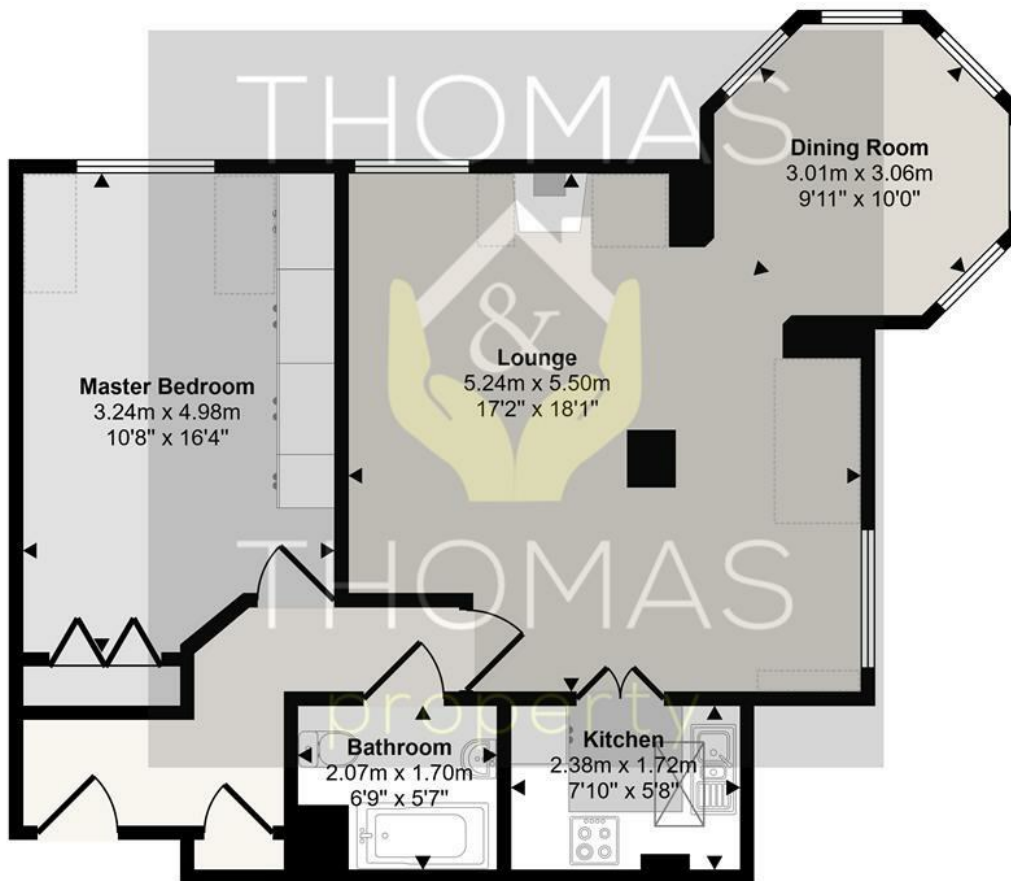

Floorplan

Denotes head height below 1.5m

This floorplan is only for illustrative purposes and is not to scale. Measurements of rooms, doors, windows, and any items are approximate and no responsibility is taken for any error, omission or mis-statement. Icons of items such as bathroom suites are representations only and may not look like the real items. Made with Made Snappy 360.

Energy Efficiency Rating		Current	Potential
Very energy efficient - lower running costs			
(92 plus) A			
(81-91) B			
(69-80) C			
(55-68) D			
(39-54) E			
(21-38) F			
(1-20) G			
Not energy efficient - higher running costs			
England & Wales		70	71
	EU Directive 2002/91/EC		

Environmental Impact (CO ₂) Rating		Current	Potential
Very environmentally friendly - lower CO ₂ emissions			
(92 plus) A			
(81-91) B			
(69-80) C			
(55-68) D			
(39-54) E			
(21-38) F			
(1-20) G			
Not environmentally friendly - higher CO ₂ emissions			
England & Wales			
	EU Directive 2002/91/EC		

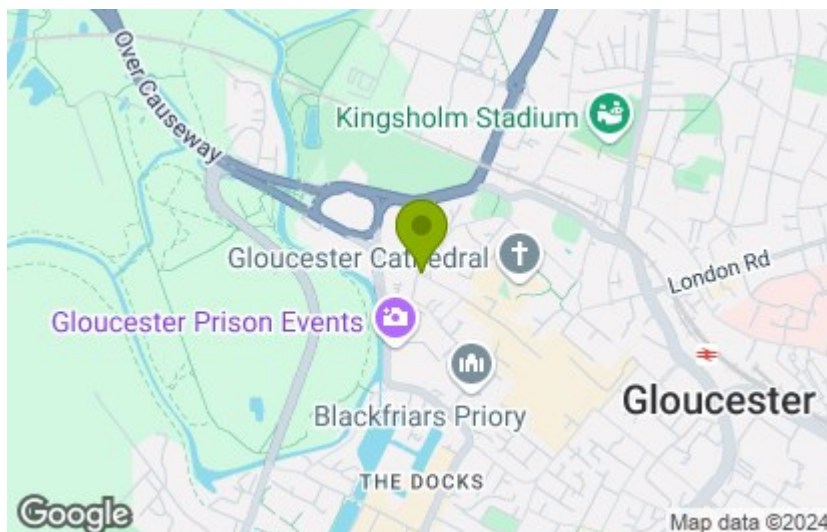

These particulars, whilst believed to be accurate are set out as a general outline only for guidance and do not constitute any part of an offer or contract. Intending purchasers should not rely on them as statements of representation of fact, but must satisfy themselves by inspection or otherwise as to their accuracy. No person in this firm's employment has the authority to make or give any representation or warranty in respect of the property.