



11 Finchmoor Mews, Gloucester, GL2 9AR

Asking Price £115,000

We are excited to be offering the beautifully presented one bedroom flat located in Longford, Gloucester. It has fantastic access to Gloucester, Cheltenham and the M5. It comprises of: a modern fitted kitchen living room, utility area leading in to the bathroom with shower over bath, double bedroom with wardrobe storage. The property is warmed via gas central heating, double glazed throughout and further benefits from one allocated parking space.

Additionally this property is available with no onward chain

- One Double Bedroom
  - First Floor
- Share of Freehold
- Allocated Parking
  - Chain Free
- Gas Central Heating

Approx Gross Internal Area  
27 sq m / 291 sq ft

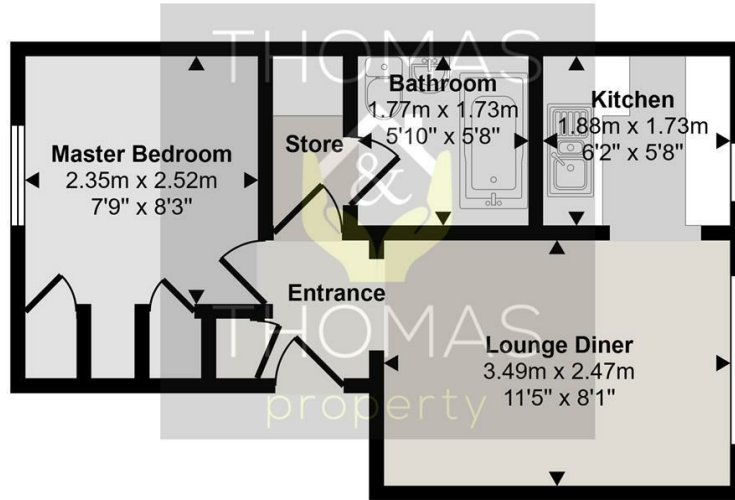

Floorplan

This floorplan is only for illustrative purposes and is not to scale. Measurements of rooms, doors, windows, and any items are approximate and no responsibility is taken for any error, omission or mis-statement. Icons of items such as bathroom suites are representations only and may not look like the real items. Made with Made Snappy 360.

Energy Efficiency Rating		Current	Potential
Very energy efficient - lower running costs			
(92 plus) <b>A</b>			
(81-91) <b>B</b>			
(69-80) <b>C</b>			
(55-68) <b>D</b>			
(39-54) <b>E</b>			
(21-38) <b>F</b>			
(1-20) <b>G</b>			
Not energy efficient - higher running costs			
<b>England &amp; Wales</b>		77	77
	EU Directive 2002/91/EC		

Environmental Impact (CO <sub>2</sub> ) Rating		Current	Potential
Very environmentally friendly - lower CO <sub>2</sub> emissions			
(92 plus) <b>A</b>			
(81-91) <b>B</b>			
(69-80) <b>C</b>			
(55-68) <b>D</b>			
(39-54) <b>E</b>			
(21-38) <b>F</b>			
(1-20) <b>G</b>			
Not environmentally friendly - higher CO <sub>2</sub> emissions			
<b>England &amp; Wales</b>			
	EU Directive 2002/91/EC		

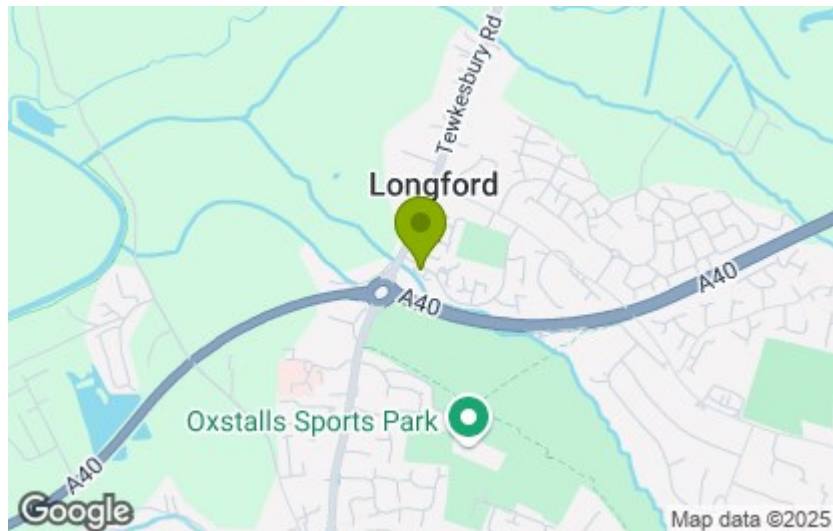

These particulars, whilst believed to be accurate are set out as a general outline only for guidance and do not constitute any part of an offer or contract. Intending purchasers should not rely on them as statements of representation of fact, but must satisfy themselves by inspection or otherwise as to their accuracy. No person in this firm's employment has the authority to make or give any representation or warranty in respect of the property.