



53 Dimore Close, Gloucester, GL2 4QQ

Offers Over £280,000

A spacious three/four bedroom detached house located with the sought after village of "Hardwicke" The property is situated within a cul-de-sac which is within walking distance to the ever popular Hardwicke Parochial Primary School.

Internally the property measures an impressive 1200 sq ft with a superb open plan kitchen/family room on the ground floor. Further accommodation comprises, a separate lounge, wc and further reception room/bedroom 4. Upstairs you will find three further bedrooms, the master with its own dressing room and a modern fitted shower room.

A full virtual tour can be found online so take a walk around and contact us to arrange your viewing.

- Three/Four Bedrooms
- Extended Accommodation
 - Cul-De-Sac Location
 - Dressing Room
- Open Plan Kitchen/Diner
 - Driveway Parking

Approx Gross Internal Area
122 sq m / 1312 sq ft

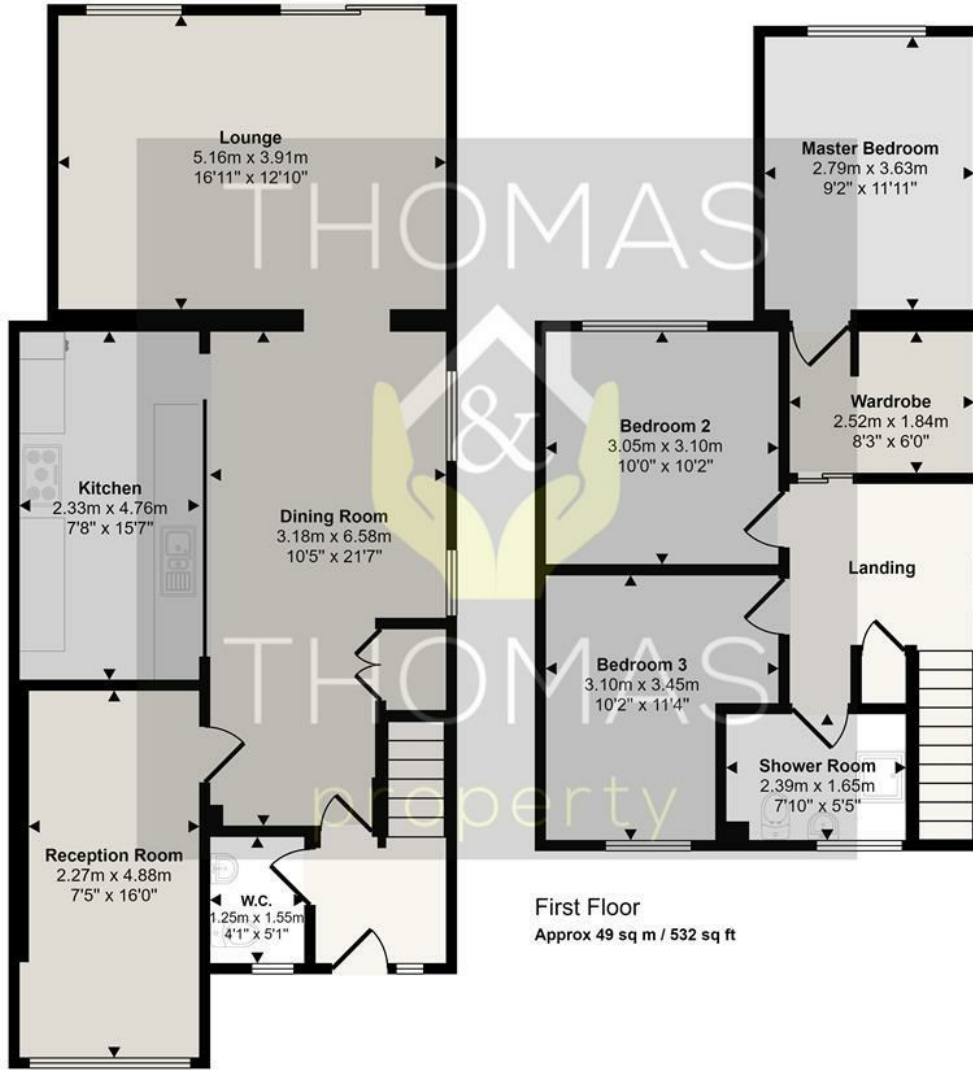

Ground Floor
Approx 72 sq m / 780 sq ft

First Floor
Approx 49 sq m / 532 sq ft

This floorplan is only for illustrative purposes and is not to scale. Measurements of rooms, doors, windows, and any items are approximate and no responsibility is taken for any error, omission or mis-statement. Icons of items such as bathroom suites are representations only and may not look like the real items. Made with Made Snappy 360.

Energy Efficiency Rating	
Current	Potential
Very energy efficient - lower running costs	
(92 plus) A	
(81-91) B	
(69-80) C	
(55-68) D	
(39-54) E	
(21-38) F	
(1-20) G	
Not energy efficient - higher running costs	
64	82
England & Wales	EU Directive 2002/91/EC

Environmental Impact (CO ₂) Rating	
Current	Potential
Very environmentally friendly - lower CO ₂ emissions	
(92 plus) A	
(81-91) B	
(69-80) C	
(55-68) D	
(39-54) E	
(21-38) F	
(1-20) G	
Not environmentally friendly - higher CO ₂ emissions	
England & Wales	EU Directive 2002/91/EC

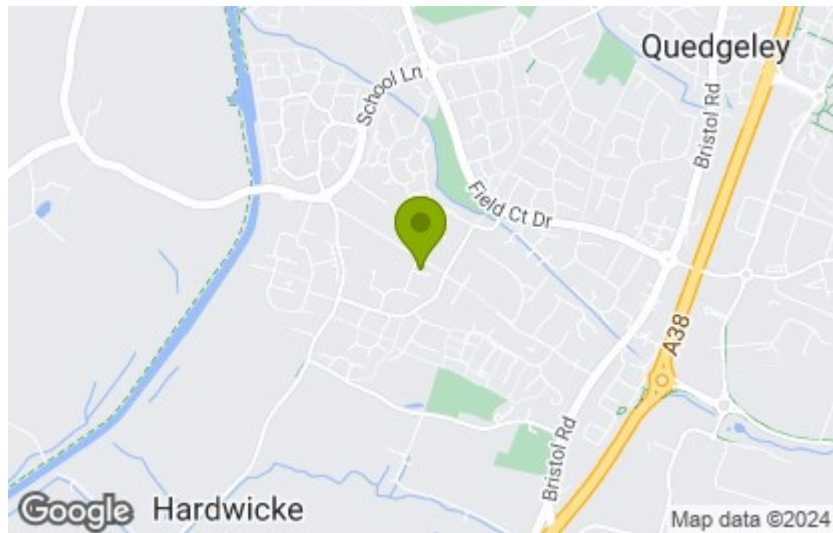

These particulars, whilst believed to be accurate are set out as a general outline only for guidance and do not constitute any part of an offer or contract. Intending purchasers should not rely on them as statements of representation of fact, but must satisfy themselves by inspection or otherwise as to their accuracy. No person in this firm's employment has the authority to make or give any representation or warranty in respect of the property.