



284 Painswick Road, Matson, Gloucester, GL4 4DR

Asking Price £195,000

A charming semi detached cottage located on Painswick Road with the benefit of driveway parking. This period property consist of an entrance hall, shower room, kitchen and one reception downstairs. Upstairs to the first floor is a double bedroom with stairs leading to a further double bedroom.

Externally the property benefits from a low maintenance garden to the side aspect with driveway parking for one vehicle. A full virtual tour can be found online.

- Two Bedrooms
- One Reception Room
 - Chain Free
- Driveway Parking
- Period Cottage
- Gas Central Heating

Approx Gross Internal Area
69 sq m / 739 sq ft

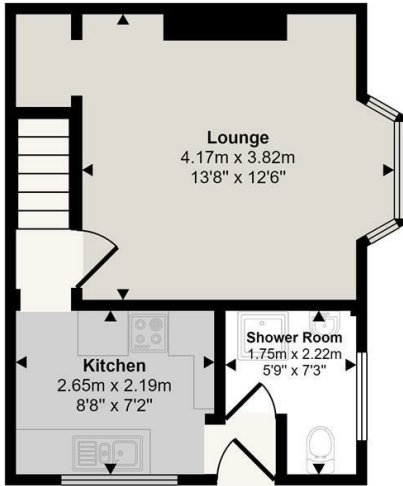

Ground Floor
Approx 29 sq m / 309 sq ft

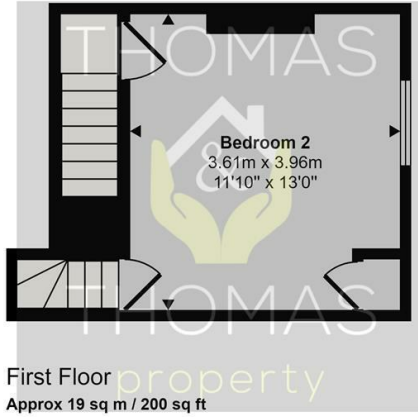

First Floor
Approx 19 sq m / 200 sq ft



Second Floor
Approx 21 sq m / 231 sq ft

This floorplan is only for illustrative purposes and is not to scale. Measurements of rooms, doors, windows, and any items are approximate and no responsibility is taken for any error, omission or mis-statement. Icons of items such as bathroom suites are representations only and may not look like the real items. Made with Made Snappy 360.

Energy Efficiency Rating	
Current	Potential
Very energy efficient - lower running costs	
(92 plus) A	82
(81-91) B	
(69-80) C	
(55-68) D	
(39-54) E	
(21-38) F	
(1-20) G	
Not energy efficient - higher running costs	
England & Wales	EU Directive 2002/91/EC

Environmental Impact (CO ₂) Rating	
Current	Potential
Very environmentally friendly - lower CO ₂ emissions	
(92 plus) A	58
(81-91) B	
(69-80) C	
(55-68) D	
(39-54) E	
(21-38) F	
(1-20) G	
Not environmentally friendly - higher CO ₂ emissions	
England & Wales	EU Directive 2002/91/EC



These particulars, whilst believed to be accurate are set out as a general outline only for guidance and do not constitute any part of an offer or contract. Intending purchasers should not rely on them as statements of representation of fact, but must satisfy themselves by inspection or otherwise as to their accuracy. No person in this firm's employment has the authority to make or give any representation or warranty in respect of the property.